

**Channel District CRA – Building Height and FAR Limits**

Base FAR = 3.5, with bonus by City approval up to 7.0.

Base Building Height = 175 feet, with bonus by City approval up to FAA limits.

**BUILDINGS**

- NEW/RENOVATED
- APPROVED/NOT COMPLETED
- CONCEPTUAL/NOT APPROVED
- UNCOMMITTED PROPERTIES
- CONTEXT







**BUILDINGS**

- NEW/RENOVATED
- APPROVED/NOT COMPLETED
- CONCEPTUAL/NOT APPROVED
- UNCOMMITTED PROPERTIES
- CONTEXT

Note: Images depict the base building height 175-foot limit (purple) and potential City approvable up to FAA limits.

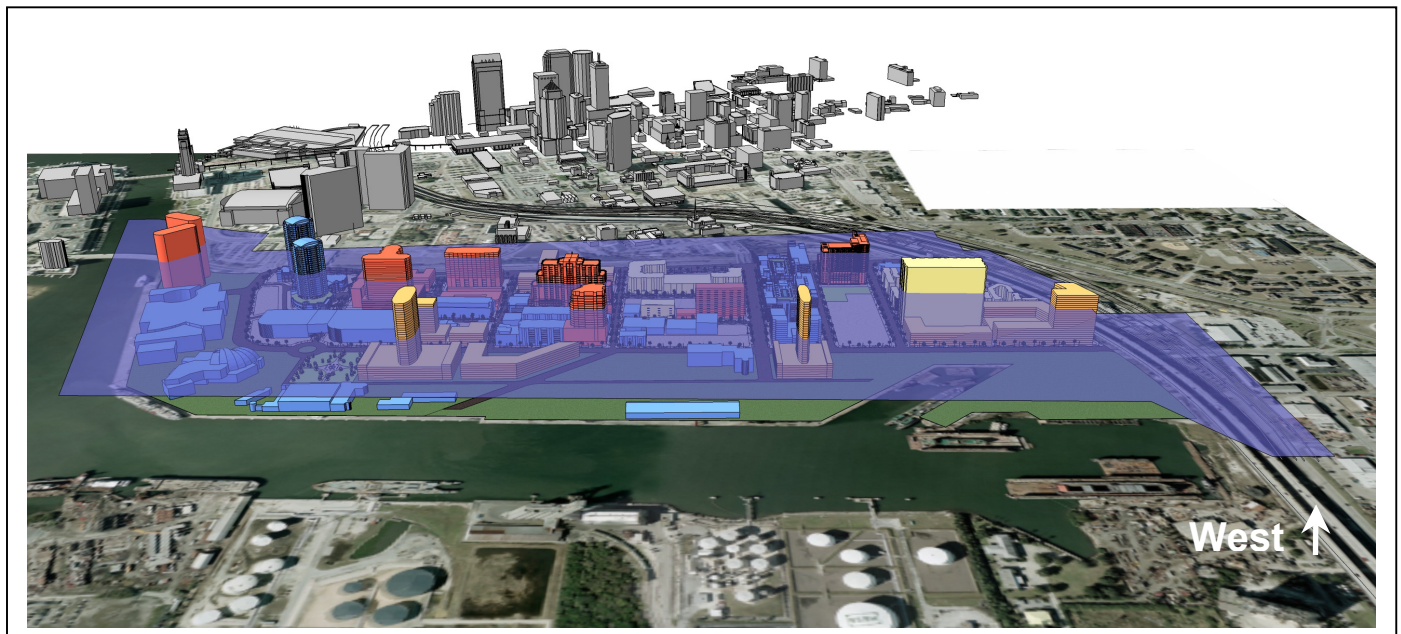
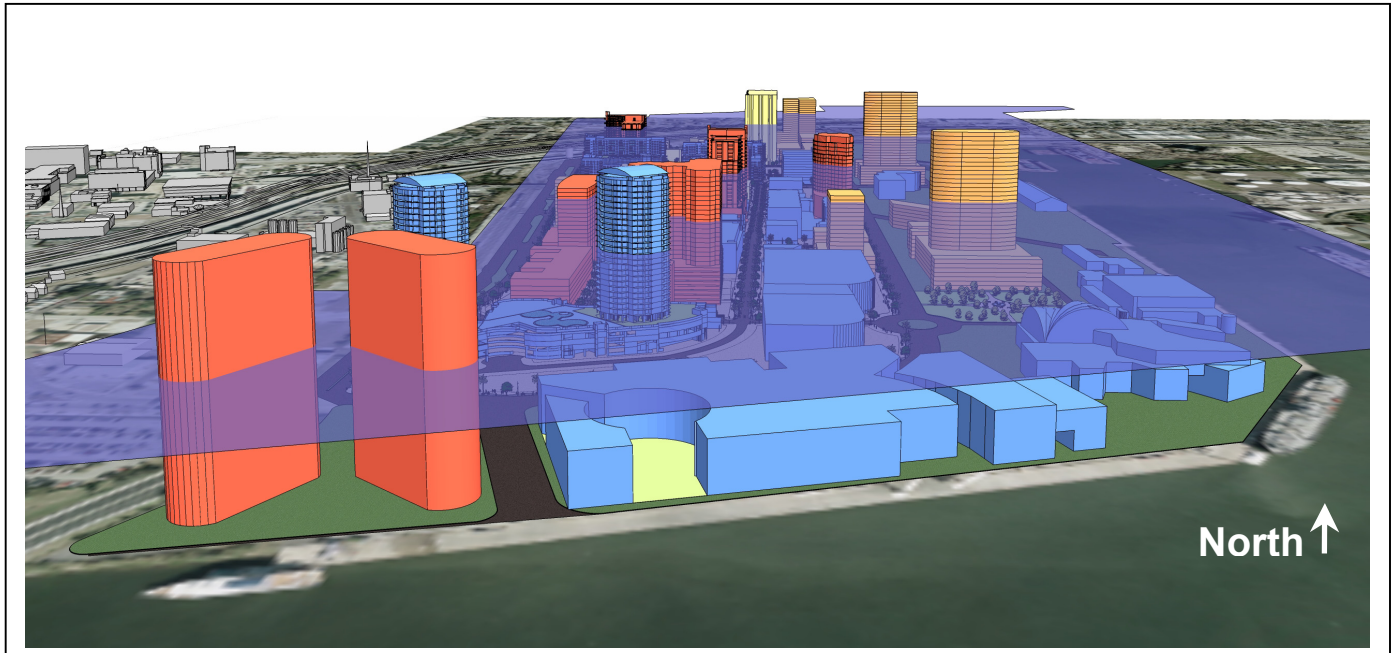





**BUILDINGS**

- NEW/RENOVATED
- APPROVED/NOT COMPLETED
- CONCEPTUAL/NOT APPROVED
- UNCOMMITTED PROPERTIES
- CONTEXT

Note: Images depict the base building height 175-foot limit (purple) and potential City approvable up to FAA limits.

